

Section 00 9113 Addendum No. 03

CHEVY COMMONS – PHASE 3
GENESEE COUNTY LAND BANK AUTHORITY
452 S. SAGINAW STREET, 2ND FLOOR
FLINT MI 48502

To all prospective bidders and others concerned, YOU ARE HEREBY ADVISED THAT the Contract Documents for the above referenced Project are revised in the following particulars:

<u>Section</u>	<u>Description of Change</u>
00 4243	<p>Replace Section 00 4243, Proposal, in its entirety due to the following changes:</p> <ol style="list-style-type: none">1. In the Base Bid Schedule, line item 19, “Fill, Non-Engineered, Site (11,500 CYD, compacted),” the estimated quantity has been revised so that the line item reads as, “Fill, Non-Engineered, Site (11,770 CYD, compacted).”2. In the Base Bid Schedule, line item 21, “Topsoil (7,250 CYD),” the estimated quantity has been revised so that the line item reads as, “Topsoil (7,380 CYD).”3. In the Base Bid Schedule, line item 24, “Temporary Boulder Edge,” is to be stricken from the Schedule.4. In the Additive Alternate Bid Schedule, line item 19B, “Fill, Non-Engineered, Site (20,000 CYD, compacted),” is to be revised to Fill, Non-Engineered, Site (11,770 CYD, compacted).5. In the Additive Alternate Bid Schedule, add line item 20A, “Fill, Non-Engineered, Rolling Meadow - Provided by Owner - (8,230 CYD, compacted)” to account for non-engineered fill material that may be made available to Contractor from 1806 East Boulevard Drive in Flint, Michigan. Material has been tested by Owner’s Representative and meets the GCLBA’s general backfill certification requirements as documented in the attached letter from AKT Peerless to the GCLBA dated April 24, 2017.6. In the Deductive Alternate Bid Schedule, line item 19C, “Fill, Non-Engineered, Site (20,000 CYD, compacted),” is to be revised to Fill, Non-Engineered, Site (11,770 CYD, compacted).7. In the Deductive Alternate Bid Schedule add a new line item, 20B, to account for approximately 8,230 CYDs of material that will be deducted from item 20 (in the Base Bid) in the event that the Owner’s Representative chooses to add item 20A from the “Additive Alternate Bid Schedule” to the Contract Price.
01 2200	<p>Replace Section 01 220, Unit Prices, in its entirety due to the revisions to the pay items described above.</p>

To all prospective bidders and others concerned, YOU ARE HEREBY ADVISED THAT the following clarifications to the Contract Documents for the above referenced Project are as follows:

Question: Section 01 2200, Unit Prices, regarding bid items 18-20 states “measurements for fill material will be in cubic yards, with the installed yardage determined by certified delivery tickets.” How many cubic yards will be paid for a gravel lead and a gravel train?

Response: Items 18-20 will be paid by lump sum. Measurement will be tracked, for reference, by certified delivery tickets. The delivery tickets will be used to calculate compacted yards in place. This calculation will be determined during construction.

Question: Section 01 2200, Unit Prices, if the quantity required exceeds the amount on the bid sheet regarding bid items 18-20, will this result in additional payment?

Response: Adjustments in quantity over or under the defined amount in the Base Bid Schedule, which was listed for reference only, will be negotiated between the Owner’s Representative and the Contractor during construction. A unit price for Engineered and Non-Engineered fill material will be established in the Additive Alternate Bid Schedule, and will serve as the basis for negotiations, depending on the final quantities.

Question: Section 01 4500, Part 1.01A states that the Engineer will perform sampling of materials in the first sentence, and in the second sentence states the Contractor shall furnish samples without charge. Please clarify which entity is responsible for providing samples and the costs associated with performing all tests (in place sampling, source qualification, compaction).

Response: Per 1.04 A of Section 01 4500, testing identified in the specifications as Source Quality Control, which is required to establish quality of materials, equipment or fabricated items, shall be paid for by the Contractor. Further, the Engineer may perform independent testing of materials, in which case, Contractor must furnish the required samples without charge.

Question: Please clarify the comment which was made at the pre-bid meeting regarding screening of material. The only mention in the specification that I could find regarding unacceptable materials was in section 31 0513.13 Part 2.01.A.4 which states “Pulverized building materials or debris shall not be used as fill materials”. This only covers artificial materials. What are the size limits for the upper limits of fill in the “non-engineered” fill areas? A standard sieve size definition for each defined material would be very helpful.

Response: In Section 00 4243, the “Fill, Non-Engineered, Site,” that is to be provided by the Owner may require screening prior to placement. If screening of the material is necessary, they shall meet the requirements listed in Section 31 0513.13, Layered Imported Soil Cap.

Question: To reduce efforts in locating an approved landfill for the contaminated material, please provide the information for the landfill approved to receive the hazardous waste material which was generated by previous phases of the project.

Response: Refer to Section 4.2.6 Materials Disposal Off-Site of the ECMP. Contaminated residual soil/solid/residual materials shall be disposed at licensed, approved Type II landfill. Contaminated residual soils or materials that are characteristically hazardous shall be disposed in an approved, licensed hazardous waste facility. Based on the results of previous subsurface activities at the subject property, characteristically hazardous materials could potentially be encountered in the course of work. The two closest Type II landfills to the project are the Brent Run Landfill located at 8247 Vienna Road in Genesee County, and Citizens Disposal Inc. located at 2361 W. Grand Blanc Road in Genesee County.

Please note that Citizens Disposal was used for materials generated during Phase 1 and Phase 2 construction activities. Further, materials disposed of by the Contractor(s) for Phase 1 and Phase 2 were characteristically non-hazardous and landfilled.

Question: From evaluating the site of the fill material that is to be provided by the Owner, it appears the quantity available may be overstated. Was the 20,000 CYD of available fill determined by a survey or rough approximation?

Response: The amount of fill material was determined by rough approximation. There were varying opinions and the amount of fill available is believed to range from 15,000 CYD to 25,000 CYD.

Question: If this quantity is not sufficient to complete the project, will the cost of securing additional material be the responsibility of the Contractor if line item 19B is utilized in determining award?

Response: No, if the fill material from line item 19B ends up being less than anticipated, the Contractor will be compensated for the additional fill material needed to meet desired grades shown in the Contract Drawings.

Question: Should hazardous/contaminated soil/material removal be separate pay item?

Response: Based on construction activities performed for both Phase 1 and Phase 2, and the subsequent material generated from these phases that required disposal, the material was characteristically non-hazardous. Contractor should make every effort to reduce the amount of material exposed during his construction activities. Further, it is not anticipated that any significant quantity of material will be exposed except in the case of the proposed storm drainage structures (Item 52 of the Base Bid Schedule) and storm sewer (Items 53 – 55 of the Base Bid Schedule). Thus, disposal of excess material generated as a result of these items should be accounted for and the cost to dispose the material at a Type II landfill should be included as part of the unit price for each item.

Question: If it rains, what should be done with any water runoff?

Response: Per Section 00 4546.39, precautions must be taken to ensure that impacted soils are protected from rainfall and storm water. Should subsurface soil become exposed, through excavation, grading, etc., appropriate action must be taken to prevent a leaching of contaminants due to storm water. Actions could include: (1) promptly returning impacted soil to the excavation, (2) removing the impacted soil to a proper disposal facility, and backfilling with clean fill material, (3) covering exposed soil with clean fill material, (4) covering impacted material with plastic sheeting, and/or (5) placement of impacted soil beneath a berm or paved areas.

Question: Is there an access issue for gravel trucks on Stevenson?

Response: Construction traffic along Stevenson was allowed for Phase 1 and Phase 2 construction activities and it is assumed that this will be the case for Phase 3.

Question: Will CADD files be made available for estimating purposes? What about TIN files for GPS-equipped construction equipment?

Response: CADD base files will be uploaded to the Wade Trim website in a zip file that may be accessed by potential bidders. TIN files will be delivered to the Contractor awarded the Contract prior to or at the Pre-Construction Meeting.

This Addendum is hereby incorporated into the original Contract Documents for the bidding referred to above and is considered as binding as though originally appearing therein. RECEIPT OF THIS ADDENDUM MUST BE NOTED in the place provided on the Proposal page 00 4243-1 and dated June 5, 2017.

Section 00 4243 Proposal

GENESEE COUNTY LAND BANK AUTHORITY
452 S. SAGINAW STREET, 2ND FLOOR
FLINT, MI 48502

Re: CHEVY COMMONS – PHASE 3

Gentlemen:

The undersigned Bidder proposes and agrees, if this Proposal is accepted, to enter into an Agreement with GENESEE COUNTY LAND BANK AUTHORITY in the form included in the Contract Documents to complete all Work as specified or indicated in the Contract Documents for the Contract Price, within the Contract Time indicated in this Bid and in accordance with the Contract Documents.

In submitting this Proposal, Bidder represents, as more fully set forth in the Agreement, that;

- a) Bidder has examined copies of all Contract Documents which he understands and accepts as sufficient for the purpose, including any and all Addenda officially issued, the receipt of which is hereby acknowledged.

Addendum No.	Date of Release	Signature

- b) Bidder has examined the surface and subsurface conditions where the Work is to be performed, the legal requirements and local conditions affecting cost, progress, furnishing or performance of the Work and has made such independent investigations as Bidder deems necessary.
- c) This Bid is genuine and not made in the interest of or on behalf of any undisclosed person, firm or corporation and is not submitted in conformity with any Agreement or rules of any group, association, organization or corporation; Bidder has not directly or indirectly induced or solicited any other Bidder to submit a false or sham Bid; Bidder has not solicited or induced any person, firm or a corporation to refrain from bidding; and Bidder has not sought by collusion to obtain for himself any advantage over any other Bidder or over OWNER's Representative's Representative.

The Bidder agrees to complete the Work, in accordance with the Contract Documents, for the following Contract Price:

Base Bid

<u>Item</u>	<u>Description</u>	<u>Quantity</u>	<u>Unit</u>	<u>Unit Price</u>	<u>Amount</u>
1.	Mobilization	1	LSUM	\$ _____	\$ _____
2.	Project Signage	1	LSUM	\$ _____	\$ _____
3.	Traffic Maintenance and Control	1	LSUM	\$ _____	\$ _____
4.	SESC Control Measures	1	LSUM	\$ _____	\$ _____
5.	Clearing, Grubbing, Tree Removal	1	LSUM	\$ _____	\$ _____
6.	Remove HMA Surface	1,160	SYD	\$ _____	\$ _____
7.	Remove Concrete Sidewalk	6,750	SFT	\$ _____	\$ _____
8.	Remove Fence	2,445	LFT	\$ _____	\$ _____

Base Bid.... Continued

<u>Item</u>	<u>Description</u>	<u>Quantity</u>	<u>Unit</u>	<u>Unit Price</u>	<u>Amount</u>
9.	Remove Concrete Curb & Gutter	215	LFT	\$ _____	\$ _____
10.	Remove Concrete Pavement	120	SYD	\$ _____	\$ _____
11.	Hydrant Removal	1	EACH	\$ _____	\$ _____
12.	Water Tank Removal	1	LSUM	\$ _____	\$ _____
13.	Structure Abandonment, Type 2	19	EACH	\$ _____	\$ _____
14.	Structure Adjustment, Monitoring Well	7	EACH	\$ _____	\$ _____
15.	Structure Adjustment, Manhole (#189)	1	EACH	\$ _____	\$ _____
16.	Structure Adjustment, Catch Basin	2	EACH	\$ _____	\$ _____
17.	Demarcation Fabric	2,260	SYD	\$ _____	\$ _____
18.	Fill, Engineered (2,800 CYD, compacted)	1	LSUM	\$ _____	\$ _____
19.	Fill, Non-Engineered, Site (11,770 CYD, compacted)	1	LSUM	\$ _____	\$ _____
20.	Fill, Non-Engineered, Rolling Meadow (10,600 CYD, compacted)	1	LSUM	\$ _____	\$ _____
21.	Topsoil (7,380 CYD)	1	LSUM	\$ _____	\$ _____
22.	Wetland Soil Mix (460 CYD)	1	LSUM	\$ _____	\$ _____
23.	Clay Cap (40 CYD)	1	LSUM	\$ _____	\$ _____
24.	Temporary Boulder Edge	350	LFT	\$ _____	\$ _____
25.	Seeding, Lowland	0.19	ACRE	\$ _____	\$ _____
26.	Seeding, Prairie	3.92	ACRE	\$ _____	\$ _____
27.	Seeding, No-Mow	1.99	ACRE	\$ _____	\$ _____
28.	Seeding, MDOT Roadside	0.49	ACRE	\$ _____	\$ _____
29.	Seeding, Rolling Meadow	2.67	ACRE	\$ _____	\$ _____
30.	Tree, 2-1/2" inch caliper, <i>Acer saccharum</i>	8	EACH	\$ _____	\$ _____
31.	Tree, 5-gallon, <i>Acer saccharum</i>	5	EACH	\$ _____	\$ _____
32.	Tree, 2" inch caliper, <i>Carpinus caroliniana</i>	6	EACH	\$ _____	\$ _____
33.	Tree, 5-gallon, <i>Carpinus caroliniana</i>	4	EACH	\$ _____	\$ _____
34.	Tree, 2-1/2" inch caliper, <i>Gymnocladus dioicus</i>	5	EACH	\$ _____	\$ _____
35.	Tree, 5-gallon, <i>Gymnocladus dioicus</i>	2	EACH	\$ _____	\$ _____
36.	Tree, 6-feet, <i>Larix laricina</i>	2	EACH	\$ _____	\$ _____
37.	Tree, 8-feet, <i>Larix laricina</i>	4	EACH	\$ _____	\$ _____
38.	Tree, 2" caliper, <i>Ostrya virginiana</i>	4	EACH	\$ _____	\$ _____
39.	Tree, 6-feet, <i>Picea dentata</i>	14	EACH	\$ _____	\$ _____
40.	Tree, 8-feet, <i>Picea dentata</i>	18	EACH	\$ _____	\$ _____
41.	Tree, 6-feet, <i>Pinus strobus</i>	12	EACH	\$ _____	\$ _____
42.	Tree, 8-feet, <i>Pinus strobus</i>	20	EACH	\$ _____	\$ _____
43.	Tree, 2-1/2" inch caliper, <i>Quercus alba</i>	6	EACH	\$ _____	\$ _____
44.	Tree, 5-gallon, <i>Quercus alba</i>	4	EACH	\$ _____	\$ _____
45.	Tree, 2-1/2" caliper, <i>Quercus macrocarpa</i>	3	EACH	\$ _____	\$ _____
46.	Tree, 6-feet, <i>Taxodium distichum</i>	2	EACH	\$ _____	\$ _____
47.	Tree, 8-feet, <i>Taxodium distichum</i>	3	EACH	\$ _____	\$ _____
48.	Tree, 5-foot Clump, <i>Amelanchier canadensis</i>	7	EACH	\$ _____	\$ _____
49.	Tree, 8-foot Clump, <i>Amelanchier canadensis</i>	10	EACH	\$ _____	\$ _____
50.	Sidewalks	12,600	SFT	\$ _____	\$ _____

Base Bid.... Continued

<u>Item</u>	<u>Description</u>	<u>Quantity</u>	<u>Unit</u>	<u>Unit Price</u>	<u>Amount</u>
51.	Curb and Gutter, F4	215	LFT	\$ _____	\$ _____
52.	Storm Drainage Structure, Catch Basin	2	EACH	\$ _____	\$ _____
53.	Storm Drainage Structure, Manhole	1	EACH	\$ _____	\$ _____
54.	Storm Sewer, 6-inch Perforated	420	LFT	\$ _____	\$ _____
55.	Storm Sewer, 8-inch HDPE	380	LFT	\$ _____	\$ _____
56.	Storm Sewer, 18-inch HDPE	110	LFT	\$ _____	\$ _____
57.	Chain Link Fencing, 6-foot	95	LFT	\$ _____	\$ _____
58.	1-Year Maintenance Contract	1	LSUM	\$ _____	\$ _____
TOTAL BASE CONTRACT PRICE (Items 1 through 58)				\$ _____	(numeric)

(In Words)

Additive Alternate Bid Schedule

<u>Item</u>	<u>Description</u>	<u>Quantity</u>	<u>Unit</u>	<u>Unit Price</u>	<u>Amount</u>
18A.	Fill, Engineered	500	CYD	\$ _____	\$ _____
19A.	Fill, Non-Engineered, Site	1,000	CYD	\$ _____	\$ _____
19B.	Fill, Non-Engineered, Site - Provided by Owner - (11,770 CYD, compacted)	1	LSUM	\$ _____	\$ _____
20A.	Fill, Non-Engineered, Rolling Meadow - Provided by Owner - (8,230 CYD, compacted)	1	LSUM	\$ _____	\$ _____
57A.	1-Year Maintenance Contract Extension (Year 2)	1	LSUM	\$ _____	\$ _____
57B.	1-Year Maintenance Contract Extension (Year 3)	1	LSUM	\$ _____	\$ _____

Deductive Alternate Bid Schedule

<u>Item</u>	<u>Description</u>	<u>Quantity</u>	<u>Unit</u>	<u>Unit Price</u>	<u>Amount</u>
19C.	Fill, Non-Engineered, Site (11,770 CYD, compacted)	1	LSUM	\$ _____	\$ _____
20B.	Fill, Non-Engineered, Rolling Meadow (8,230 CYD)	1	LSUM	\$ _____	\$ _____

The undersigned, as Bidder, hereby certifies that he or a qualified designated person in his employ has examined the Contract Documents provided by the OWNER's Representative for bidding purposes. Further, the undersigned certifies that he or his qualified employee has reviewed the Bidder's proposed construction methods and finds them compatible with the conditions and from the information provided for Bidding.

The undersigned, as Bidder, shall complete the Work under any job circumstances or field conditions present and/or ascertainable prior to bidding. In addition, he shall also complete the Work under whatever conditions he may create by his own sequence of construction, construction methods, or other conditions he may create, at no additional cost to the OWNER's Representative.

The undersigned, as Bidder, declares that he has familiarized himself with the location of the proposed Work and the conditions under which it must be constructed. Also, that he has carefully examined the Plans, the Specifications, and the Contract Documents, which he understands and accepts as sufficient for the purpose, and agrees that he will Contract with the OWNER's Representative to furnish all labor, material, tools, and equipment necessary to do all Work specified and prescribed for the completion of the Project.

The undersigned agrees, if awarded Contract, to sign the Agreement and submit satisfactory bonds and certificates of insurance coverage and other evidence of insurance required by the Contract Documents within fifteen (15) days after the date of OWNER's Representative's Notice of Award.

The undersigned agrees that time is of the essence and, if awarded Contract, that the Work will be Substantially Completed within One-Hundred Twenty (120) calendar days of the issuance of the Notice to Proceed, and completed and ready for final payment within One-Hundred Eighty (180) calendar days of the issuance of the Notice to Proceed and in accordance with paragraph 14.11 of the General Conditions.

Liquidated damages, as specified in the General Conditions, Supplementary Conditions and Agreement, shall also apply to the above Substantial Completion date.

Engineering and inspection costs incurred after Final Completion shall be paid by CONTRACTOR to OWNER's Representative, as specified in the Conditions of the Contract.

Proposals may not be withdrawn for a period of ninety (90) days after bid opening.

The following documents are attached to and made a condition of this Proposal:

a) Required Bid security in the form checked below:

Certified Check Cashier's Check Money Order Bid Bond

b) Legal Status of Bidder.

c) Bidder's Name: _____

By: _____

Address: _____

Phone No.: _____ Fax No.: _____

Email: _____

Section 01 2200 Unit Prices

Part 1 General

1.01 Scope

- A. This Section describes the method of measurement and basis of payment for all items of Work included in the Contract and specified in the Proposal.
- B. CONTRACTOR shall provide labor, material, tools, equipment and services required to complete the Work specified herein and indicated on the Plans.
- C. OWNER's Representative will make no allowances for items not included in Section 00 4243, Proposal.

1.02 Items of the Proposal

Item 1

Mobilization will be paid for at the Contract Unit Price on a Lump Sum basis. Price paid shall be payment in full for labor, material, and equipment necessary for preparatory work and operations, including, but not limited to, those necessary for the movement of personnel, equipment, supplies, and incidentals to the project site; for the establishment of the specified field offices and other facilities necessary to undertake the work on the project; and for other work and operations which must be performed, or for expenses incurred, prior to beginning work on the various contract items on the project site. It shall also include preconstruction costs, including insurance and bonds, exclusive of bidding costs, which are necessary direct costs to the project and are of a general nature rather than directly attributable to other pay items under the contract. Payment for mobilization will be based upon the following schedule:

Partial Payment Schedule

Percentage of Original Contract Amount Earned	Percentage of Bid Price for Mobilization Allowed
5	50
10	75
25	100

Item 2

Project Signage will be paid for at the Contract Unit Price on a Lump Sum basis. Price paid shall be payment in full for labor, material, and equipment required for furnishing and installing project signage and shall include, but is not limited to, installation, sign supports, mounting brackets, hardware, removal of signage at project completion, and other items necessary to complete the job whether specifically mentioned or implied.

Item 3

Traffic Maintenance and Control will be paid for at the Contract Unit Price on a Lump Sum basis. Price paid shall be payment in full for labor, material, and equipment required for maintaining traffic, and shall include, but is not limited to, furnishing, installing, operating, and maintaining barricades, lighted arrow boards, drums, traffic control devices, signs, channeling devices, cones, flagmen, flag control, pavement markings, warning flashers, concrete barriers, minor traffic devices, and other items necessary to complete the job, whether specifically mentioned or implied.

Item 4

SESC Measures will be paid for at the Contract Unit Price on a Lump Sum basis. Price paid shall be payment in full for labor, material, and equipment required for furnishing, installing, and maintaining soil erosion control devices as shown on the plans or as determined by ENGINEER and shall include, but is not limited to, furnishing, installing, and maintaining, geotextile silt fence, straw bales, sediment traps, filter bags, establishing permanent erosion control, removal of devices, and other items necessary to complete the job, whether specifically mentioned or implied.

Item 5

Clearing, Grubbing, Tree Removal will be paid for at the Contract Unit Price per Lump Sum. Price paid shall be payment in full for labor, material, and equipment necessary for clearing and grubbing and shall include, but is not limited to cutting; chipping; removing and disposing of designated trees; removal of stumps, brush, hedges, roots, corduroy, logs, matted roots, other vegetation and debris; protection of plant life, existing structures and improvements not designated for removal; excavation and backfill, backfilling of holes, protection of existing improvements, barricading, disposal of removed material, and for all items necessary to complete the job, whether specifically mentioned or implied.

Item 6

Remove HMA Surface, will be paid for at the Contract Unit Price per Square Yard. Price paid shall be payment in full for labor, material, and equipment required for removal of the existing asphalt pavement, as shown on the Plans, and shall include, but is not limited to, protection of existing improvements, sawcutting, excavation, removal and disposal of existing pavement unless material, backfilling, barricading, restoration, and other items necessary to complete the job, whether specifically mentioned or implied. Measurement for removal of HMA surface will be by square yard field measured in place.

Item 7

Remove Concrete Sidewalk, of the type and thickness specified on the Plans, will be paid for at the Contract Unit Price per Square Foot. Price paid shall be payment in full for labor, material, and equipment necessary for the removal of the sidewalk, including sidewalk ramps, and approaches and shall include, but is not limited to, protection of existing improvements, sawcutting, removal and disposal of existing sidewalk and approach materials, backfilling, barricading, restoration, and other items necessary to complete the job, whether specifically mentioned or implied. Measurement for removal of sidewalks and approaches will be determined by square yard field measured in place.

Item 8

Remove Fence will be paid for at the Contract Unit Price per Linear Foot. Price paid shall be payment in full for labor, material, and equipment required to remove the existing fence in the designated locations, as shown on the Plans, or as determined by ENGINEER, and shall include, but is not limited to, the removing, fence, gates, posts, and all attached parts, protection of existing improvements, barricading, disposal of removed material, and items necessary to complete the job, whether specifically mentioned or implied. Measurement for removing fence will be in linear feet, determined by field measure along the bottom of the fence with no deduction for gate openings.

Item 9

Remove Concrete Curb and Gutter will be paid for at the Contract Unit Price per Linear Foot. Price paid shall be payment in full for labor, material, and equipment necessary for the removal of concrete curb and gutter, as shown on the Plans or as determined by ENGINEER, and shall include, but is not limited to, saw cutting, removal and disposal of unsuitable materials, furnishing, placing and compacting backfill, protection of existing improvements, barricading, and for other items necessary to complete the job, whether specifically mentioned or implied.

Measurement for removing concrete curb and gutter will be in linear feet in place, determined by field measure.

Item 10

Remove Concrete Pavement, of the type and thickness specified on the Plans, will be paid for at the Contract Unit Price per Square Yard. Price paid shall be payment in full for labor, material, and equipment necessary for the removal of concrete pavement and shall include, but is not limited to, protection of existing improvements, sawcutting, removal and disposal of existing pavement materials, backfilling, barricading, restoration, and other items necessary to complete the job, whether specifically mentioned or implied. Measurement for removal of concrete pavement will be determined by square yard field measured in place.

Item 11

Hydrant Removal will be paid for at the Contract Unit Price per Each. Price paid shall be payment in full for labor, material, and equipment necessary for removing fire hydrant, and shall include, but is not limited to, necessary excavation, sheeting, bracing, shoring, and dewatering, protection of existing improvements, removal of fire hydrant back to valve, capping of existing water main, at the valve backfill, backfilling, disposal of excess excavated material, and other items necessary to complete the job, whether specifically mentioned or implied. Removing fire hydrant will be measured as units removed.

Item 12

Water Tank Removal will be paid for at the Contract Unit Price on a Lump Sum basis. Price paid shall be payment in full for all labor, material, and equipment necessary to remove and salvage a water storage tank, and shall include but is not limited to, removal and salvaging associated piping and appurtenances from the tank, and all other items necessary to complete the job, whether specifically mentioned or implied.

Item 13

Structure Abandonment, of the type specified, will be paid for at the Contract Unit Price on a per Each basis. Price paid shall be payment in full for labor, material and equipment necessary to abandon designated structures, as shown on the Plans, and shall include, but is not limited to, replacing existing cover with solid cover, furnishing and installing a steel plate where the existing cover is missing, bulkheading ends of abandoned sewers or culverts, flowable fill, protection of existing improvements and utilities, removal and disposal of unsuitable and excess material, miscellaneous restoration, and items necessary to complete the job, whether specifically mentioned or implied.

Item 14 - 16

Structure Adjustment, of the type specified, will be paid for at the Contract Unit Price per Each. Price paid shall be payment in full for labor, material, and equipment required to raise the frame and cover on an otherwise sound structure. This work shall include, but is not limited to, sawcutting, removal and disposal of pavement, excavation, construction, bricks, blocks, precast adjustment rings, PVC pipe, or other materials necessary to adjust the designated structure, masonry plaster coat, backfill, concrete, installation of frame and cover, cleanout of structure, and other items necessary to complete the job, whether specifically mentioned or implied.

Item 17

Demarcation Fabric, shall be paid for at the Contract Unit Price per Square Yard. Price paid shall be payment in full for labor, material and equipment required for furnishing and placing demarcation fabric in the areas shown on the Contract Drawings, or as directed by ENGINEER, and shall include, but is not limited to, all subgrade preparation, cutting and fitting fabric, stapling, staking or pegging fabric in place, and other items necessary to complete the Work, whether specifically mentioned or implied.

Item 18 - 20

Fill, of the type and thickness specified, as well as the location, on the Plans, will be paid for at the Contract Unit Price per Lump Sum. Price paid shall be payment in full for labor, material, and equipment necessary for installation of fill material in accordance with the cross section shown on the Plans or as determined by ENGINEER, and shall include, but is not limited to protection of existing improvements, spreading, grading, shaping, compacting, removal and disposal of excess or unsuitable material, material testing, furnishing and applying water as necessary, and for all items necessary to complete the job, whether specifically mentioned or implied. Measurements for fill material will be in cubic yards, with the installed yardage determined by certified delivery tickets submitted to ENGINEER or his duly authorized representative at the time of placement.

Item 18A - 20A, 19C

Fill, of the type and thickness specified, as well as the location, on the Plans, will be paid for at the Contract Unit Price per Cubic Yard Price paid shall be payment in full for labor, material, and equipment necessary for installation of fill material in accordance with the cross section shown on the Plans or as determined by ENGINEER, and shall include, but is not limited to protection of existing improvements, spreading, grading, shaping, compacting, removal and disposal of excess or unsuitable material, material testing, furnishing and applying water as necessary, and for all items necessary to complete the job, whether specifically mentioned or implied. Measurements for fill material will be in cubic yards, with the installed yardage determined by certified delivery tickets submitted to ENGINEER or his duly authorized representative at the time of placement.

Item 19B -20B

Fill, of the type specified, will be paid for at the Contract Unit Price per Cubic Yard Price paid shall be payment in full for labor, material, and equipment necessary for the transportation, screening and installation of fill material provided by OWNER from 1806 East Boulevard Drive in Flint, Michigan, in accordance with the cross section shown on the Plans or as determined by ENGINEER, and shall include, but is not limited to protection of existing improvements, spreading, grading, shaping, compacting, removal and disposal of excess or unsuitable material, material testing, furnishing and applying water as necessary, and for all items necessary to complete the job, whether specifically mentioned or implied. Material has been tested by Owner's Representative and meets the GCLBA's general backfill certification requirements as documented in the attached letter from AKT Peerless to the GCLBA dated April 24, 2017 and the laboratory test results dated April 20, 2017.

Item 21

Topsoil, of the depth specified, will be paid for at the Contract Unit Price per Lump Sum. Price paid shall be payment in full for labor, material, and equipment necessary for installation of topsoil in accordance with the cross section shown on the Plans or as determined by ENGINEER, and shall include, but is not limited to protection of existing improvements, spreading, grading, shaping, plowing, discing, raking, rolling, tamping, disposing of unsuitable material and excess material, material testing, and all items necessary to complete the job, whether specifically mentioned or implied. Delivery tickets shall indicate the scale weight of the material, including moisture content.

Item 22

Wetland Soil Mix, will be paid for at the Contract Unit Price per Lump Sum. Price paid shall be payment in full for labor, material, and equipment necessary for installation of wetland soil mix in accordance with the cross section shown on the Plans or as determined by ENGINEER, and shall include, but is not limited to protection of existing improvements, spreading, grading, shaping, plowing, discing, raking, rolling, tamping, disposing of unsuitable material and excess material, material testing, and all items necessary to complete the job, whether specifically mentioned or implied. Delivery tickets shall indicate the scale weight of the material, including moisture content.

Item 23

Clay Cap, of the type and thickness specified on the Plans, will be paid for at the Contract Unit Price per Lump Sum. Price paid shall be payment in full for labor, material, and equipment necessary for installation of cap material in accordance with the cross section shown on the Plans or as determined by ENGINEER, and shall include, but is not limited to protection of existing improvements, spreading, grading, shaping, compacting, removal and disposal of excess or unsuitable material, material testing, and for all items necessary to complete the job, whether specifically mentioned or implied. Delivery tickets shall indicate the scale weight of the material, including moisture content.

Item 24

~~**Temporary Boulder Edge**, of the size and type specified, will be paid for at the Contract Unit Price per Lineal Foot. Price paid shall be payment in full for labor, material, and equipment necessary to install the boulder edge and shall include, but is not limited to, geotextile fabric, installation of landscape boulder, and other items necessary to complete the job, whether specifically mentioned or implied. Measurement for the temporary boulder edge will be in linear feet in place, determined by field measure.~~

Item 25 - 29

Seeding, of the type specified will be paid for at the Contract Unit Price per Acre of area seeded. Price paid shall be payment in full for providing all labor, material, and equipment, necessary for seeding and shall include, but is not limited to, all soil preparation, providing topsoil, grading, shaping, placing and spreading topsoil, seeding, mulching, mulch anchoring, fertilizing, discing and harrowing, rolling, watering, mowing, lawn establishment, reseeding and all other items necessary to complete the job, whether specifically mentioned or implied. CONTRACTOR shall seed all areas disturbed by his operations. Seeding will be field measured by area in acres for the areas indicated on the plans to be seeded. Areas disturbed outside of the areas indicated on the plans shall be seeded at CONTRACTOR's expense.

Item 30 - 49

Tree, of the type and indicated in the Proposal, will be paid for at the Contract Unit Price per Each. Price paid shall be payment in full for all labor, material, and equipment necessary for tree planting and shall include, but is not limited to, selection and transporting trees, protection of trees, hole excavation, tree pruning, tree planting, topsoil or planting mixture backfilling, mulching, watering, guying and bracing, tree wrapping, tree dressing, warranting tree establishment, cleanup and all other items necessary to complete the job, whether specifically mentioned or implied.

Item 50

Sidewalks, of the thickness specified on the Plans, will be paid for at the Contract Unit Price per Square Foot. Price paid shall be payment in full for labor, material, and equipment necessary for sidewalks, sidewalk ramps and approaches and shall include, but is not limited to, excavation, construction, protection of existing improvements, undercutting and backfilling the subgrade, compacting and fine grading subgrade, furnishing, placing, and compacting backfill and subbase, construction of expansion joints, also forming, placing, jointing, finishing and curing the concrete, construction of detectable warning, providing protection against rain and cold weather, barricading, restoration, and other items necessary to complete the job, whether specifically mentioned or implied. Measurement for will be determined by field measure of sidewalks, sidewalk ramps and approaches in place. Sidewalk ramps will be measured from back of curb to the key flag or to the end of the monolithic rolled curb, whichever is less.

Item 51

Concrete Curb and Gutter, of the type and width specified will be paid for at the Contract Unit Price per Linear Foot. Price paid shall be payment in full for labor, material, and equipment necessary for the concrete curb and gutter section and shall include, but is not limited to,

sawcutting, excavation, construction, protection of existing improvements, furnishing, placing, and compacting backfill and subbase, compacting and fine grading subgrade, providing and installing hook bolt assemblies, tie bar assemblies, reinforcing steel, also forming, placing, jointing, finishing, texturing and curing the concrete, furnishing, placing, and hand patching bituminous pavement along the new curb and gutter, providing protection against rain and cold weather, backfilling, barricading, restoration, gapping, and other items necessary to complete the job, whether specifically mentioned or implied. Measurement for concrete curb and gutter will be determined by field measure of curb and gutter in place.

Item 52 - 53

Storm Drainage Structure, of the type and diameter indicated, for depths up to eight (8) feet and for the first eight (8) feet of deeper structures, will be paid for at the Contract Unit Price per Each. Price paid shall be payment in full for labor, material, and equipment necessary for a complete standard storm drainage structure, and shall include but is not limited to, excavation, dewatering, construction, frame, cover, bricks, blocks, cone section, riser sections, top section, bottom section, masonry plaster coat, steps, sand backfill, barricading, restoration, and other items necessary to complete the job, whether specifically mentioned or implied.

Item 54 - 56

Storm Sewer, of the diameter and type specified, jacked-in-place, will be paid for at the Contract Unit Price per Linear Foot. Price paid shall be payment in full for labor, material, and equipment required for storm sewer jacked-in-place and shall include, but is not limited to, excavation, sheeting, shoring, bracing and dewatering, jacking pits, receiving pits, disposal of excess excavated material, protection of existing improvements, jacking storm sewer, steel ring joints, grouting sewer, backfilling boring and receiving pits, final inspection which includes cleaning, connections to manholes or sewers, and other items necessary to complete the job, whether specifically mentioned or implied. Measurement for storm sewer jacked-in- place will be by linear feet determined by field measure of the storm sewer not exposed by open cut.

Item 57

Chain Link Fencing, of the height specified, will be paid for at the Contract Unit Price per Linear Foot of fence in place. Price paid shall be payment in full for all labor, material, and equipment necessary for fencing and shall include, but is not limited to, all fittings and hardware, excavation, concrete foundations, line posts, end posts, corner posts, angle posts, intersection and intermediate braced posts, rails, tension wire, bracing, post caps, post extensions, barbed wire, fence fabric, gate posts, gates, gate hardware, pickets, stretcher bars, tie wire, fasteners, backfilling, restoration, cleanup and all other items necessary to complete the job, whether specifically mentioned or implied. Measurement for fence will be taken from end to end along the bottom of the installed fencing with no deduction for gate openings.

Item 58

1-Year Maintenance Contract, will be paid for at the Contract Unit Price on a Lump Sum basis. Price paid shall be payment in full for all labor, material, and equipment required for maintaining all planted material in a vigorous, healthy, sound growing condition for a 1-year period starting from the date Substantial Completion is achieved by CONTRACTOR and ending after 365 calendar days. Maintenance shall include, but is not limited to, cultivating; weeding; pruning; watering as required to establish healthy, viable plantings but no less than 1-inch per week, unless regular rainfall occurs; mowing; fertilizing; mulching; re-guying; repairing or replacing damaged, diseased, dead, or infested plant material; and all other items necessary to complete the job, whether specifically mentioned or implied, for the period of the maintenance contract.

Item 58A

1-Year Maintenance Contract Extension (Year 2), will be paid for at the Contract Unit Price on a Lump Sum basis. Price paid shall be payment in full for all labor, material, and equipment required for maintaining all planted material in a vigorous, healthy, sound growing condition for an additional 1-year period from the end of the prior year's maintenance and ending after 365 calendar days. Maintenance shall include, but is not limited to, cultivating; weeding; pruning; watering as required to establish healthy, viable plantings but no less than 1-inch per week, unless regular rainfall occurs; mowing; fertilizing; mulching; re-guying; repairing or replacing damaged, diseased, dead, or infested plant material; and all other items necessary to complete the job, whether specifically mentioned or implied, for the period of the maintenance contract.

Item 58B

1-Year Maintenance Contract Extension (Year 3), will be paid for at the Contract Unit Price on a Lump Sum basis. Price paid shall be payment in full for all labor, material, and equipment required for maintaining all planted material in a vigorous, healthy, sound growing condition for an additional 1-year period from the end of the prior year's maintenance and ending after 365 calendar days. Maintenance shall include, but is not limited to, cultivating; weeding; pruning; watering as required to establish healthy, viable plantings but no less than 1-inch per week, unless regular rainfall occurs; mowing; fertilizing; mulching; re-guying; repairing or replacing damaged, diseased, dead, or infested plant material; and all other items necessary to complete the job, whether specifically mentioned or implied, for the period of the maintenance contract.

Part 2 Products (Not Used)

Part 3 Execution (Not Used)

End of Section

PROJECT MANAGER: David Anthony
 C:\PW_WORK\2\00741734\CSP-PLTS-SITE-PLAN.DWG - C-2.0 - PLOTTED: 6/22/2017 9:15 AM BY: HARRISON, DAVID

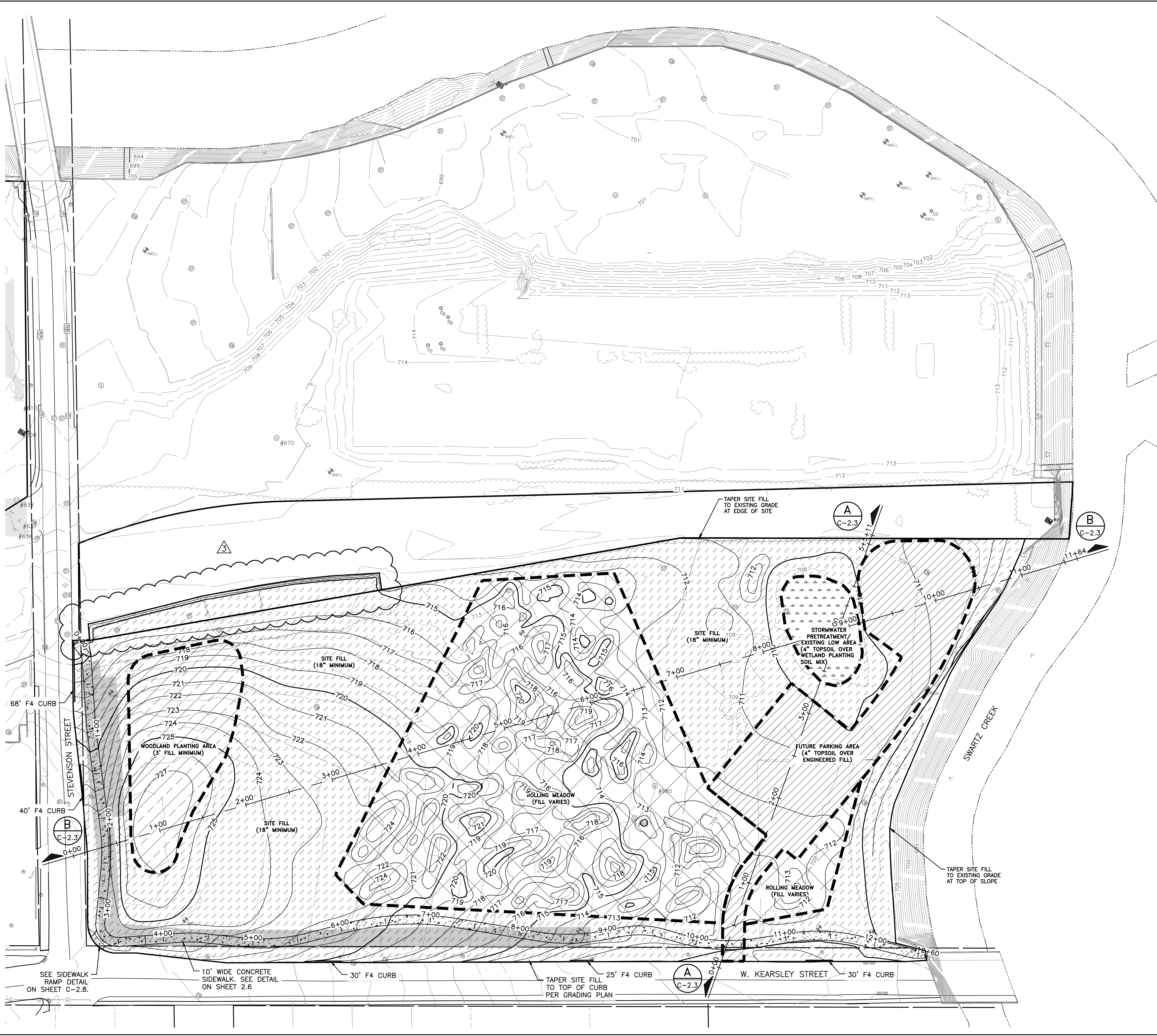

LEGEND

	STORMWATER PRETREATMENT/ EXISTING LOW AREA
	FUTURE PARKING AREA
	ROLLING MEADOW
	WOODLAND PLANTING AREA
	SITE FILL
	DEMARCATON FABRIC

GENESEE COUNTY LAND BANK AUTHORITY
CHEVY COMMONS
PHASE 3
 SITE AND CAP PLAN

ISSUED FOR: BID DATE: 4/11/17 BY: DLH

JOB NO. GPA2002-01F

SHEET C-2.0

WADETRIM
 555 South Saginaw Street, Suite 201
 Flint, MI 48902-0034, 1.0942
 810.910.2355 ext. 400
 www.wadetrtrim.com

Building relationships on a foundation of excellence

REV#	DATE	DESCRIPTION
3	6/5/17	REVISED PER APPENDIX #3
2	5/15/17	REVISED PER APPENDIX #2
		DLH
		TLH
		BY

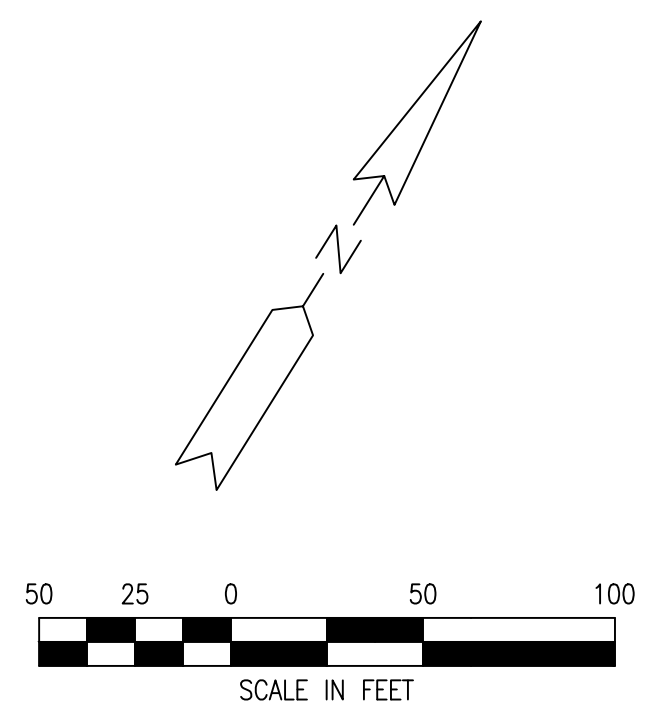

PHASE 3 ESTIMATED VOLUMES
(FOR INFORMATION ONLY)

MATERIAL	VOLUME (CYDS)	VOLUME (TONS)	EST. UNIT WT (lbs/cft)
ENGINEERED FILL - PARKING AREA (18")	2,790	4,520	120
WETLAND PLANTING SOIL - LOW AREA (14") MIN	460	683	110
TOPSOIL (6")	6,770	10,053	110
TOPSOIL (4")	610	906	110
FILL, SITE, NON-ENGINEERED	11,770	20,656	130
FILL, ROLLING MEADOW, NON-ENGINEERED	10,560	18,533	130
CLAY CAP	40	68	125
TOTAL FILL	32,960		

POINT TABLE

POINT #	NORTHING	EASTING	ELEVATION
1	552080.1394	13300981.2784	714.98
2	552088.3437	13300987.6910	715.20
3	552020.8354	13301024.0464	718.66
4	552026.6800	13301032.1606	718.89
5	552009.9609	13301032.4468	719.37
6	552016.3360	13301040.1512	719.64
7	551929.8753	13301098.8885	723.93
8	551936.2597	13301106.5852	723.99
9	551892.0164	13301123.4996	723.92
10	551896.4593	13301132.4584	723.98
11	551839.2148	13301149.6855	723.69
12	551843.6577	13301158.6443	723.92
13	551830.0716	13301186.7425	723.00
14	551837.3468	13301179.7389	723.20
15	551878.2708	13301236.2692	723.43
16	551870.1706	13301242.1332	723.01
17	551892.2290	13301259.6220	723.47
18	551883.7468	13301265.0504	723.16
19	551911.0089	13301298.4144	722.66
20	551902.0082	13301302.7717	722.20
21	551951.2565	13301353.9016	721.72
22	551944.3198	13301361.1045	721.32
23	551985.1506	13301386.5435	721.89
24	551978.2139	13301393.7464	721.32
25	552055.1989	13301489.1179	718.01
26	552045.9655	13301492.9577	717.72
27	552089.6716	13301572.0135	714.66
28	552080.4382	13301575.8533	714.24
29	552127.1265	13301631.0391	712.50
30	552119.7202	13301637.7581	712.11
31	552144.1338	13301649.7859	0.00
32	552136.7274	13301656.5050	0.00
33	552167.3419	13301691.5424	711.38
34	552157.7253	13301694.2847	711.10
35	552172.0660	13301708.1090	0.00
36	552162.4494	13301710.8513	0.00
37	552212.1958	13301782.3053	710.15
38	552204.6371	13301788.8525	709.52
39	552236.4352	13301810.2895	710.28
40	552228.8765	13301816.8367	709.71
41	552276.1250	13301880.1727	709.96
42	552266.6302	13301883.3110	709.91

ELEVATIONS TABLE

NUMBER	MIN ELEV	MAX ELEV	COLOR
1	-4.5	-3.5	Blue
2	-3.5	-2.5	Dark Blue
3	-2.5	-1.5	Light Blue
4	-1.5	0.0	Lightest Blue
5	0.0	1.5	Yellow
6	1.5	2.0	Light Green
7	2.0	3.0	Light Green
8	3.0	4.0	Green
9	4.0	7.9	Dark Green

WADETRIM
 555 South Saginaw Street, Suite 201
 Flint, MI 48902 (508)941.0242
 FAX (517)252.5456
 www.wadetrtrim.com

GENESEE COUNTY LAND BANK AUTHORITY
CHEVY COMMONS
PHASE 3
GRADING PLAN

ISSUED FOR: DATE: BY:
 BID: GPA2002-01F 4/11/17 DLH

SHEET
C-2.1

PROJECT MANAGER: David Anthony
 CIVIL WORKS: JODI WILSON
 FIELD BOOK INFORMATION: C-2.1 - PLOTTED: 6/2/2017 9:18 AM BY: HARRISON, DAVID
 PROJECT: CHEVY COMMONS PHASE 3 GRADING PLAN